

BUTU WARGUN DRIVE, PEMULWUY
LANDSCAPE DA PACKAGE

Table with 3 columns: DWG, DRAWING TITLE, SCALE. Rows include LA00 COVER SHEET AND CONTEXT PLAN, LA01 SITE PLAN, LA02 KEY LANDSCAPE CHARACTERS, LA03 TREE REMOVAL AND RETENTION PLAN, LA04 COMMUNAL OPEN SPACE LANDSCAPE PLAN, LA05 POCKET PARK LANDSCAPE PLAN, LA06 GREEN ROOF LANDSCAPE PLAN, LA07 LANDSCAPE SECTIONS, LA08 PLANTING PLAN 1/4, LA9 PLANTING PLAN 2/4, LA10 PLANTING PLAN 3/4, LA11 PLANTING PLAN 4/4, LA12 LANDSCAPE DETAILS.

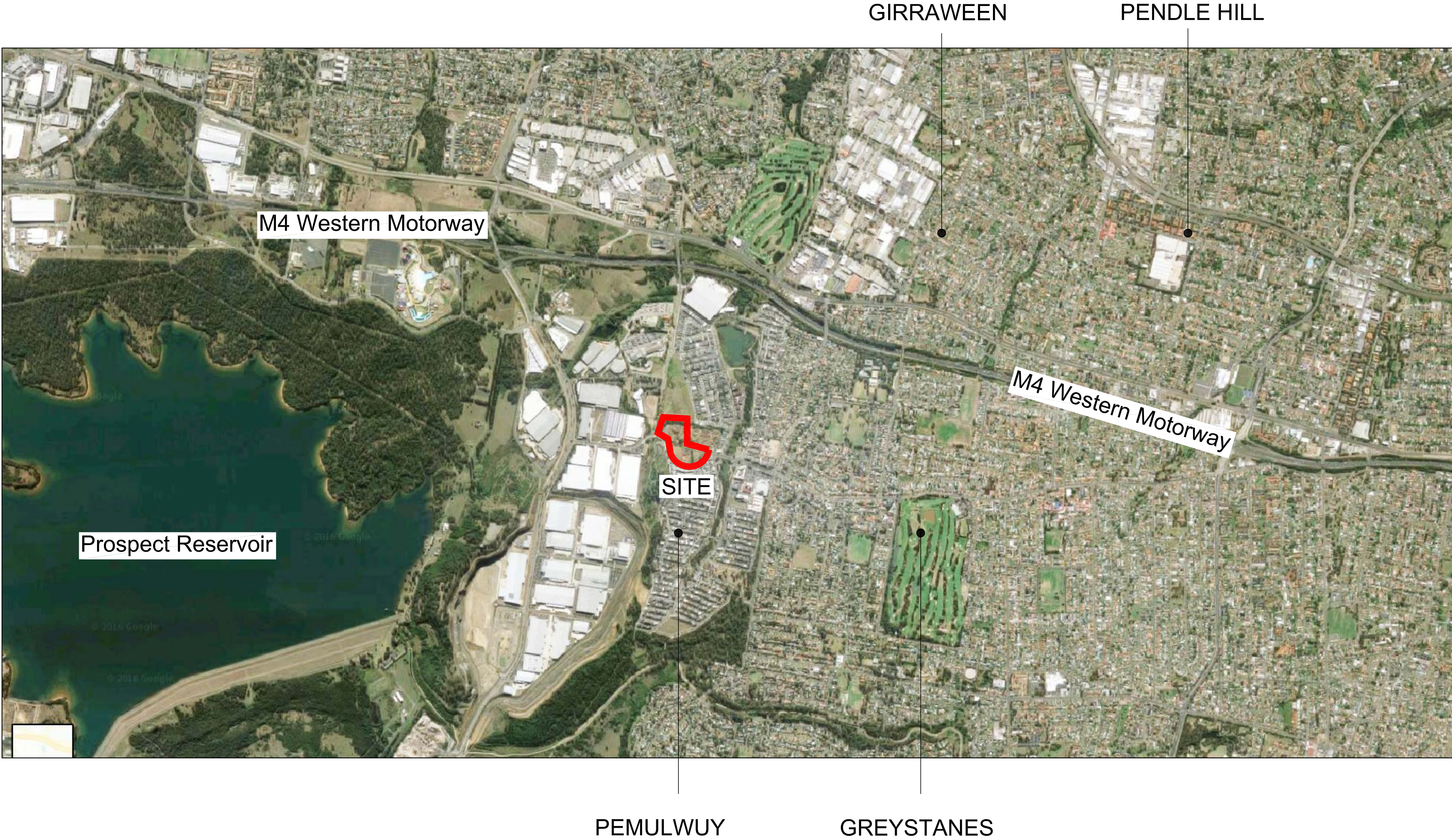

LOCAL CONTEXT PLAN

PLANT SCHEDULE - BUTU WARGUN DRIVE
Table with 5 columns: ID, BOTANICAL NAME, COMMON NAME, MATURE HEIGHT (m), POT SIZE, QTY.
Sections include: WUSD RAIN GARDEN- STREET FRONTAGE, WUSD DRY CREEK BED AREA, Private Park, COURT GARDEN, PUBLIC PARK.

DESIGN STATEMENT:

The landscape architectural proposal aims to deliver a series of public and private external spaces that foster a sense of community, promote activity and embrace and integrate ecology and nature within the development.

Key areas of the design include the creation of communal open space located to the west of the site. This communal space creates a series of meaningful spaces for residents providing opportunities for community gatherings within the community centre and BBQ area. The community centre is co-located with active and passive play elements including multi-purpose sports court, rope play / hammock structures, open lawn for active plan and a fruiting orchard. Vegetation is of a predominantly native character with trees selectively located on the western boundary to maximise views to and from the adjacent SHR Prospect Hill ridgeline.

Linking the upper communal park within the development, is a series of terraced landscape areas and articulated stairs to the lower external spaces. A dry creek bed links the upper park to the external spaces between Blocks A and B which is connected with WSUD applications throughout the development to clean and filter surface water, assist in ground water recharge and provide ecological benefit and amenity. Numerous pocket parks are located throughout the development providing opportunities for passive and semi active play and activity. These pocket parks integrate nature within the development and introduce the benefits of Ecological Sustainable Development that the development aims to achieve. Pocket parks will be furnished with a variety of seating opportunities, open lawns, pergolas and paved areas as per the plans.

The development aims to “give back” to the greater community by creating a public park for use by all. The public park provides a multitude of active and passive elements within including water play elements complemented by seating, shade structures, and raised deck with a universally trafficable paved surround. The public park maintains opportunities for the integration of playground elements within the open space to provide a variety of opportunities for play throughout the year. Community engagement will be encouraged with opportunities for local artistic input to further create a unique and memorable space and street front address to Butu Wargun Drive.





LEGEND

- A** Communal open space with multi purpose court and community centre
- B** Wsud feature linking upper terraces to communal open space
- C** Residential pocket park
- D** Terraced landscape
- E** Productive orchard
- F** Central fernery garden with full height building void over
- G** Articulated stair for site connectivity
- H** Public open space with playground elements
- I** Localised WSUD treatment
- J** Native screen planting to boundary. Fencing to Architect's details.
- K** Endemic street trees
- L** Green roof

**TaylorBrammer**

TAYLOR BRAMMER LANDSCAPE ARCHITECTS PTY LTD  
SYDNEY STUDIO

218 Oxford Street  
Woollahra, NSW, 2025

T 61 2 9387 8855  
F 61 2 9387 8155  
E sydney@taylorbrammer.com.au

LEGEND:

|          |                     |  |                         |  |                   |  |                 |
|----------|---------------------|--|-------------------------|--|-------------------|--|-----------------|
| EX 18.25 | SITE BOUNDARY       |  | EXISTING STREET TREE    |  | PROPOSED PLANTING |  | ACCESSIBLE PATH |
| RL 20.0  | EXISTING SPOT LEVEL |  | PROPOSED TREE           |  | TURF              |  | PERGOLA AREA    |
| TW 21.0  | PROPOSED SPOT LEVEL |  | PROPOSED WSUD TREATMENT |  | DECK AREA         |  |                 |
| SL 24.00 | TOP OF WALL LEVEL   |  |                         |  |                   |  |                 |
|          | TOP OF SLAB LEVEL   |  |                         |  |                   |  |                 |

|       |                              |            |
|-------|------------------------------|------------|
| E     | REDUCED GREEN ROOF           | 21.02.2018 |
| D     | UPDATED GREEN ROOF           | 18.07.2017 |
| C     | REVISED DA                   | 27.02.2017 |
| B     | REVISED DA                   | 02.02.2017 |
| A     | FOR DA                       | 26.08.2016 |
| P2    | PRELIMINARY FOR COORDINATION | 23.08.2016 |
| P1    | PRELIMINARY FOR COORDINATION | 16.08.2016 |
| ISSUE | DESCRIPTION                  | DATE       |

PROJECT:  
LOTS 12 + 13 BUTU WARGUN DRIVE  
PEMULWUY

DRAWING TITLE:  
SITE MASTER PLAN

CLIENT:  
MINTUS HOLDINGS Pty Ltd.ATF  
THE PEMULWUY INVESTMENT UNIT TRUST

SCALE: 1:500 @A1

CHECKED: DMT  
DRAWN: ND

JOB NO: 16-1285  
DESIGNED: AL

DRAWING NO: LA01  
REVISION: E

Copyright of Taylor Brammer Landscape Architects Pty Ltd.  
ABN 61 098 724 988



KEY LANDSCAPE CONCEPT



A Communal open space      E Productive orchard



B WSUD Treatment

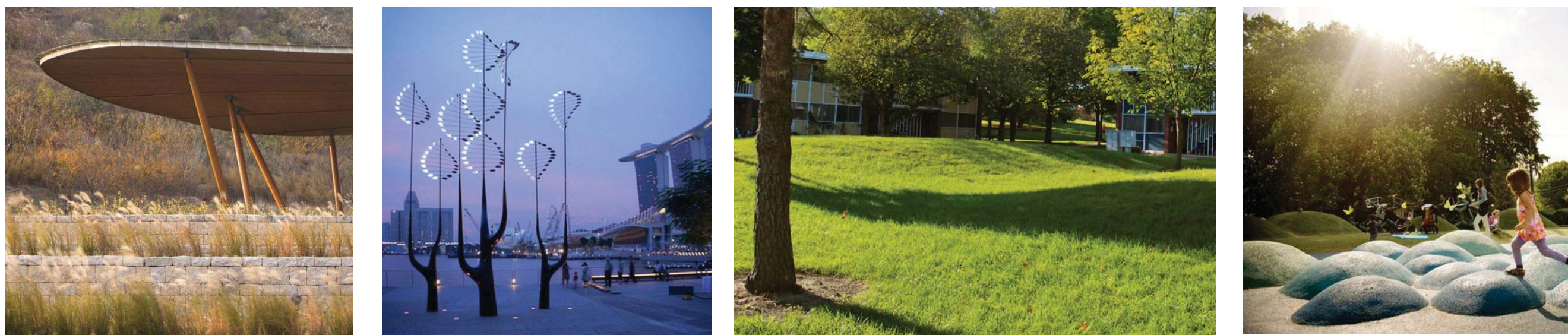

H Residential Pocket Park

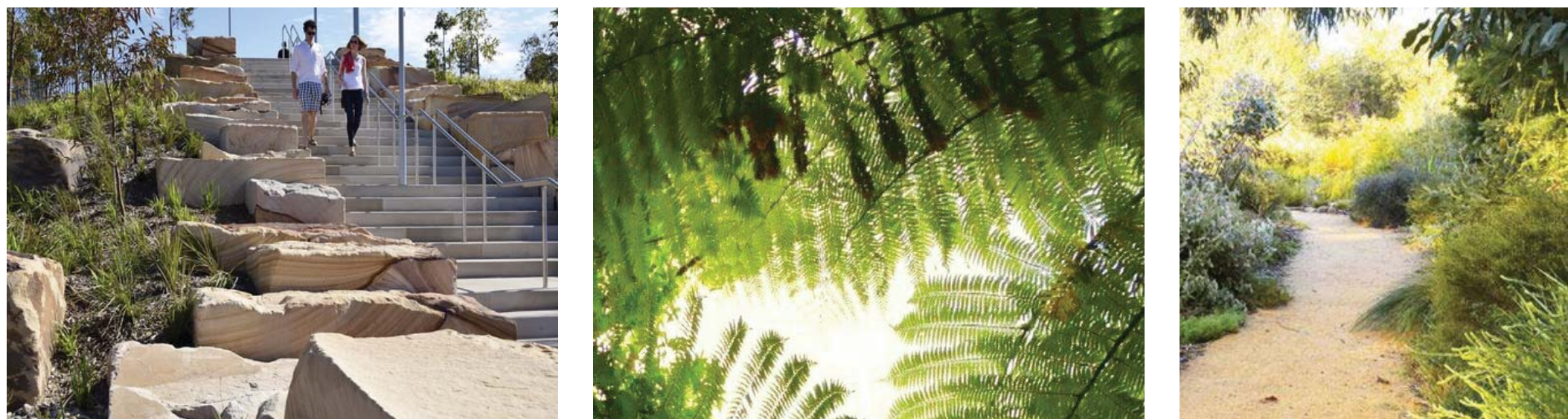

D Terraced Landscape Area





LEGEND

- A** Multipurpose court
- B** Community centre with BBQ and seating facilities
- C** Open space for active use
- D** Passive edge with hammock/rope structures
- E** Accessible community orchard with textured planting and fruiting trees
- F** Terraced Landscape
- G** Articulated stair with look out platform encouraging site connectivity.
- H** Pocket park with seatings
- I** Localised WSUD treatment
- J** Feature paving area
- K** Native screen planting to boundary. Fencing to Architect's details.
- L** Central fernery garden with full height building void over

|          |  |                     |  |                         |  |                   |  |                 |  |
|----------|--|---------------------|--|-------------------------|--|-------------------|--|-----------------|--|
| LEGEND:  |  | SITE BOUNDARY       |  | EXISTING STREET TREE    |  | PROPOSED PLANTING |  | ACCESSIBLE PATH |  |
| EX 18.25 |  | EXISTING SPOT LEVEL |  | PROPOSED TREE           |  | TURF              |  | PERGOLA AREA    |  |
| RL 20.0  |  | PROPOSED SPOT LEVEL |  | PROPOSED WSUD TREATMENT |  | DECK AREA         |  |                 |  |
| TW 21.0  |  | TOP OF WALL LEVEL   |  |                         |  |                   |  |                 |  |
| SL 24.00 |  | TOP OF SLAB LEVEL   |  |                         |  |                   |  |                 |  |

|  |  |   |  |  |  |
|--|--|---|--|--|--|
| PROJECT: LOTS 12 & 13 BUTU WARGUN DRIVE PEMULWAY |  | DRAWING TITLE: COMMUNAL OPEN SPACE LANDSCAPE PLAN |  | CLIENT: MINTUS HOLDINGS Pty. Ltd ATF THE PEMULWY INVESTMENT UNIT TRUST       |  |
| E REDUCED GREEN ROOF 21.02.2018                  |  | D UPDATED GREEN ROOF 18.07.2017                   |  | C REVISED DA 27.02.2017  |  |
| B REVISED DA 02.02.2017                          |  | A FOR DA 26.08.2016                               |  | P2 PRELIMINARY FOR COORDINATION 23.08.2016                                   |  |
| P1 PRELIMINARY FOR COORDINATION 18.08.2016       |  | DATE  |  | ISSUE DESCRIPTION  |  |
| 0 2.5 5 10 15m                                   |  | SCALE: 1:250 (A1)                                 |  | CHECKED: DMT   |  |
|  |  | CREATED: 18.08.2016                               |  | JOB NO: 16-1285  |  |
|  |  | DRAWN: ND   |  | DESIGNED: AL   |  |
|  |  |   |  | LA04   |  |
|  |  |   |  | E  |  |
|  |  |   |  | Copyright of Taylor Brammer Landscape Architects Pty Ltd. AIN 61 098 724 988 |  |





LEGEND

- A** Elevated Deck with feature tree creating focal point to park
- B** Pedestrian Access
- C** Play element as per council details, to be developed further at a later date with Council. To be included in conditions of consent.
- D** Shade structure with BBQ, drinking fountain and seating to be developed further at a later date with Council
- E** Green Island with feature tree
- F** Kinetic Sculptures to boundary to highlight park and encourage use
- G** Open Green Space for active use
- H** Boundary fence to Architect's details
- I** Sandstone retaining walls
- J** Native Screen Planting to Boundary. Fencing to Architect's details.
- K** Endemic Street Trees
- L** Central fernery garden with full height building void over
- M** Proposed location of 3m wide vehicular access gate with entry wall and name to future Council details
- N** Underground stormfilter vault to Engineer's details



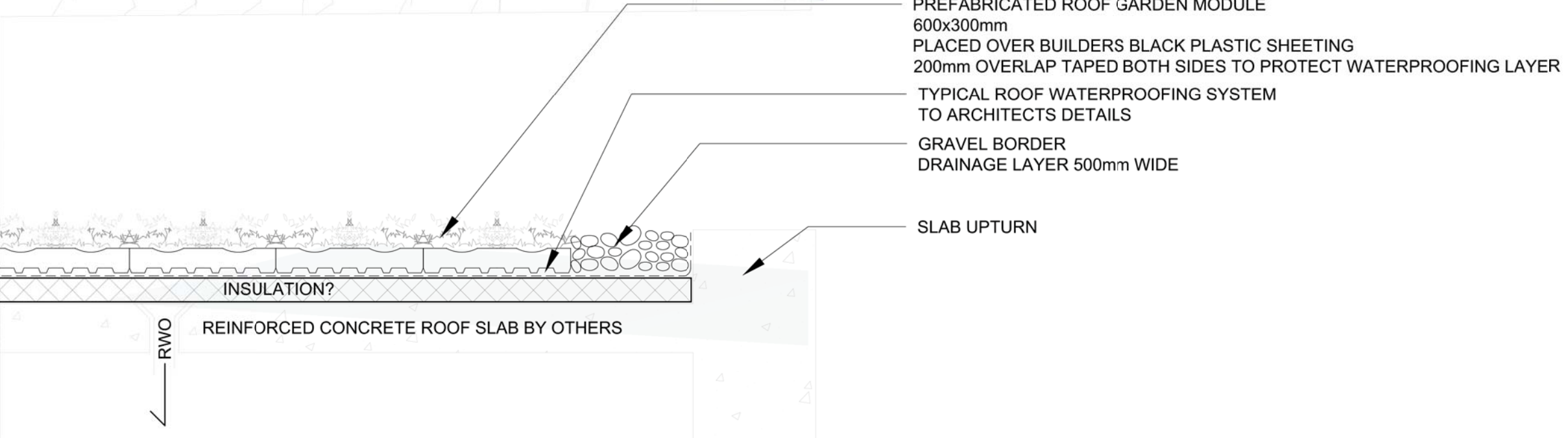

ROOF GARDEN MODULE  
TYPICAL SECTION 1:20

GREEN ROOF PLANT SCHEDULE - BUTU WARGUN DRIVE

| ID                                 | BOTANICAL NAME                                | COMMON NAME        | HEIGHT (m) | POT SIZE | QTY  |
|------------------------------------|---|--------------------|------------|----------|------|
| PLANTING MIX A (4/M <sup>2</sup> ) |   |                    |            |          |      |
| Ec-el                              | <i>Echeveria elegans</i>                      | Mexican Gem        | 0.3        | 150mm    | 1298 |
| Se-ma                              | <i>Senecio mandraliscae</i>                   | Blue Chalk Sticks  | 0.45m      | 150mm    | 1298 |
| Ec-gr                              | <i>Echeveria Echeveria elegans 'Grey Red'</i> | Hen and Chicks     | 0.3        | 150mm    | 1298 |
| Se-re                              | <i>Sedum reflexum 'Blue Spruce'</i>           | Blue Stonecrop     | 0.12       | 150mm    | 1298 |
| PLANTING MIX B (4/M <sup>2</sup> ) |   |                    |            |          |      |
| Ro-pl                              | <i>Rosularia platyphylla</i>                  | Rosularia          | 0.15       | 150mm    | 1345 |
| Se-se                              | <i>Sedum sexangulare</i>                      | Tasteless Stoncrop | 0.1        | 150mm    | 1345 |
| Se-de                              | <i>Sedum dendroideum</i>                      | Bush Sedum         | 0.9        | 150mm    | 1345 |
| Se-ro                              | <i>Senecio rowleyanus</i>                     | String of pearls   | -          | 150mm    | 1345 |
| PLANTING MIX C (4/M <sup>2</sup> ) |   |                    |            |          |      |
| Se-ce                              | <i>Sempervivum arachnoideum 'Cebanese'</i>    | Spring Mother Hen  | 0.5        | 150mm    | 1423 |
| Cr-ov                              | <i>Crassula ovata</i>                         | Jade Plant         | 0.7        | 150mm    | 1423 |
| Se-bl                              | <i>Sedum album 'Black Pearl'</i>              | Stonecrop          | 0.7        | 150mm    | 1423 |
| Ka-th                              | <i>Kalanchoe thyrsiflora</i>                  | Flapjacks          | 0.4        | 150mm    | 1423 |

NOTE:  
\* Plant quantities on planting plan take precedence over quantities identified in this schedule.



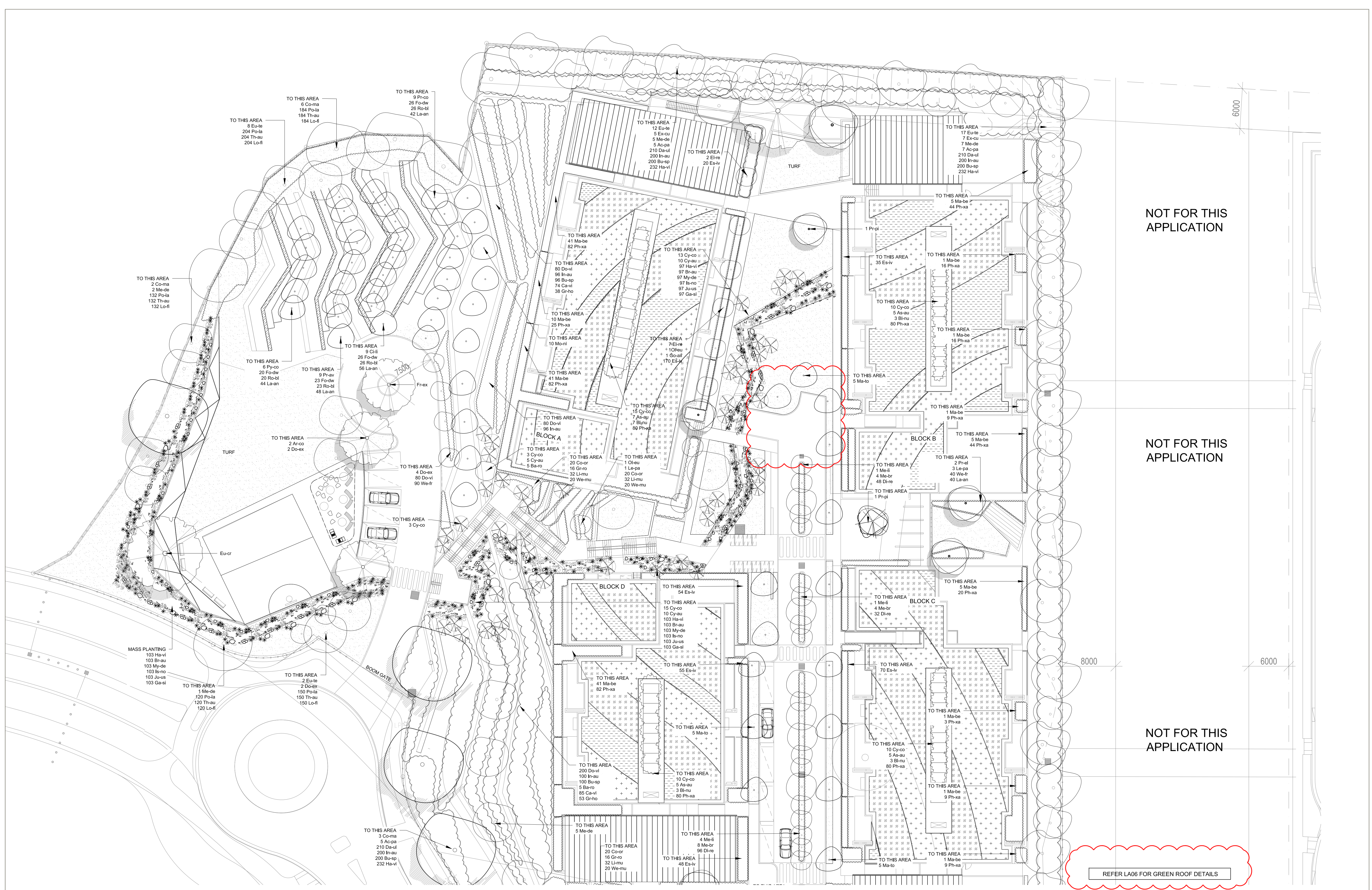

NOT FOR THIS APPLICATION

NOT FOR THIS APPLICATION

NOT FOR THIS APPLICATION

REFER LA06 FOR GREEN ROOF DETAILS

TaylorBrammer

TaylorBrammer Landscape Architects Pty Ltd

Sydney Studio

218 Oxford Street  
Woolahra, NSW, 2025

T 61 2 9387 8855  
F 61 2 9387 8155  
E sydney@taylorbrammer.com.au

LEGEND:

—

× EX 18.25

+RL 20.0

+TW 21.0

+SL 24.00

SITE BOUNDARY

EXISTING SPOT LEVEL

PROPOSED SPOT LEVEL

TOP OF WALL LEVEL

TOP OF SLAB LEVEL

EXISTING STREET TREE

PROPOSED TREE

PROPOSED WSUD TREATMENT

PROPOSED PLANTING

TURF

DECK AREA

ACCESSIBLE PATH

PERGOLA AREA

PROJECT:  
LOTS 12 + 13 BUTU WARGUN DRIVE  
PEMULWAY

DRAWING TITLE:  
PLANTING PLAN 1/4

SCALE: 1:250 @A1  
CREATED: 16.08.2016  
DRAWN: ND

CHECKED: DMT  
JOB NO: 16-1265  
DESIGNED: AL

DRAWING NO:  
LA08

REVISION:  
D

D REDUCED GREEN ROOF 21.02.2018

C UPDATED GREEN ROOF 16.07.2017

B REVISED DA 27.02.2017

A REVISED DA 02.02.2017

ISSUE DESCRIPTION DATE

CLIENT:  
MINTUS HOLDINGS Pty. Ltd.ATF  
THE PEMULWUY INVESTMENT UNIT TRUST

Copyright of Taylor Brammer Landscape Architects Pty Ltd.  
ABN 61 096 724 988



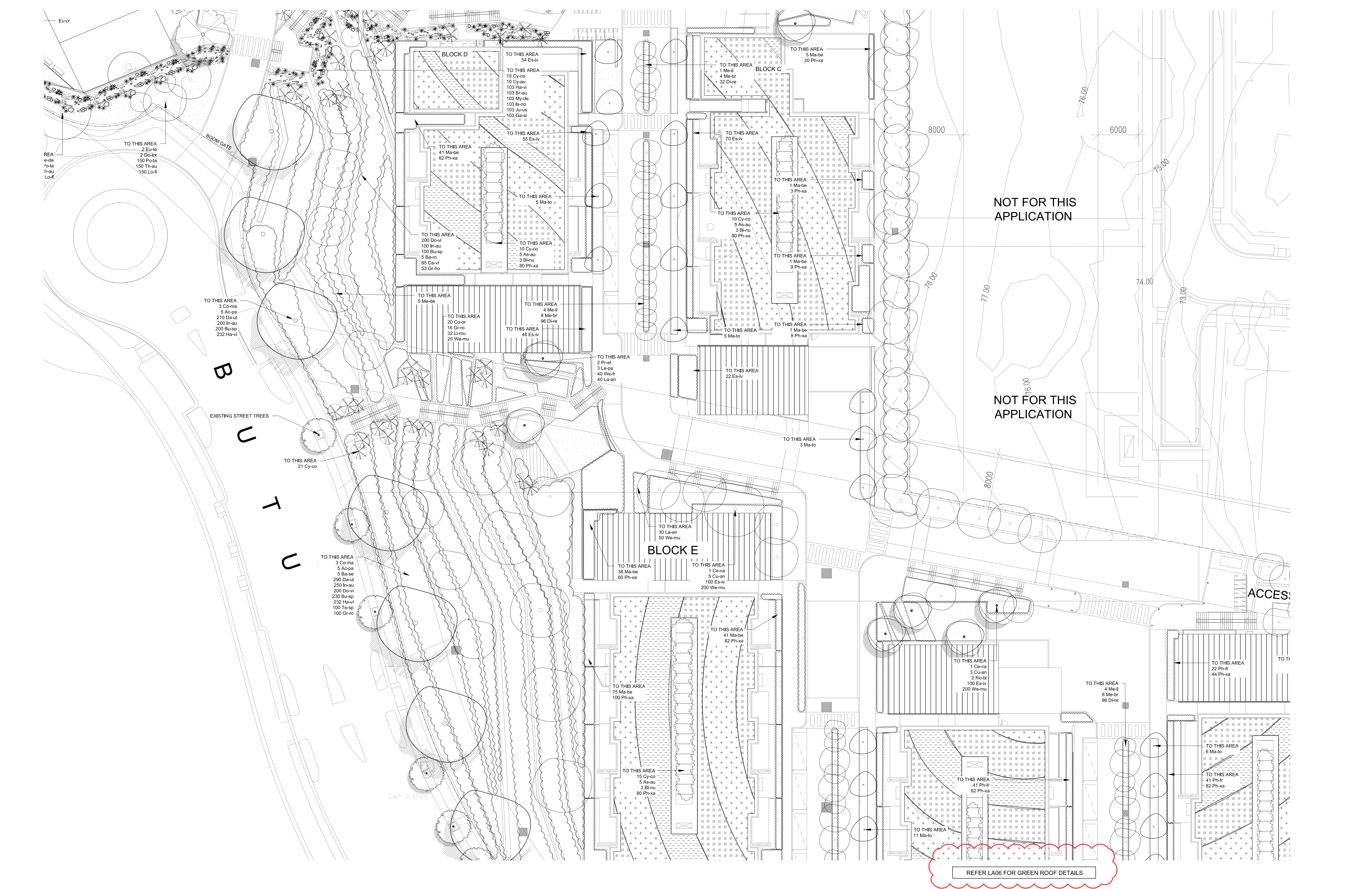

TaylorBrammer

Taylor Brammer Landscape Architects Pty Ltd

Sydney Studio

218 Oxford Street  
Woolloomah, NSW, 2025

T 61 2 9387 8855

F 61 2 9387 8150

E sydney@taylorbrammer.com.au

LEGEND:

× EX 18.25

+RL 20.0

+TW 21.0

+SL 24.00

SITE BOUNDARY

EXISTING SPOT LEVEL

PROPOSED SPOT LEVEL

TOP OF WALL LEVEL

TOP OF SLAB LEVEL

EXISTING STREET TREE

PROPOSED TREE

PROPOSED WSUD TREATMENT

PROPOSED PLANTING

TURF

DECK AREA

ACCESSIBLE PATH

PERGOLA AREA

PROJECT:  
LOTS 12 + 13 BUTU WARGUN DRIVE  
PEMULWAY

DRAWING TITLE:  
PLANTING PLAN 2/4

SCALE: 1:250 @A1

CREATED: 16.08.2016

DRAWN: ND

CHECKED: DMT

JOB NO: 16-1265

DESIGNED: AL

D 21.02.2018

C 18.07.2017

B 27.02.2017

A 02.02.2017

ISSUE DESCRIPTION

DATE

CLIENT:  
MINTUS HOLDINGS Pty. Ltd.ATF  
THE PEMULWUY INVESTMENT UNIT TRUST

LA09 D

0 2.5 5 10 15m

Copyright of Taylor Brammer Landscape Architects Pty Ltd.  
ABN 61 098 724 988



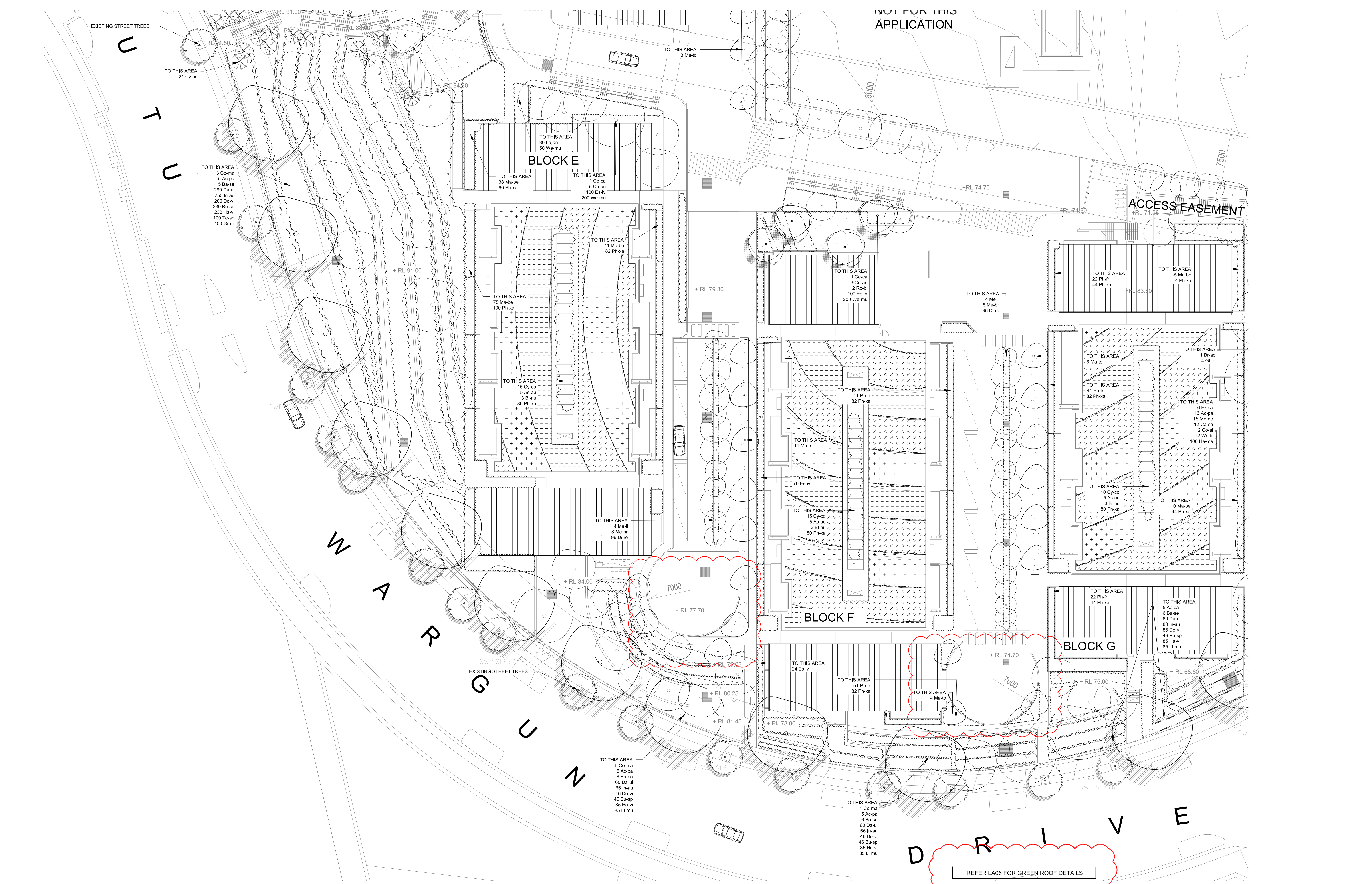

TaylorBrammer

218 Oxford Street  
Woolahra, NSW, 2025

T 61 2 8387 8855  
F 61 2 8387 8155  
E sydney@taylorbrammer.com.au

LEGEND:

SITE BOUNDARY

×

EX 18.25

+RL 20.0

PROPOSED SPOT LEVEL

+TW 21.0

TOP OF WALL LEVEL

+SL 24.00

TOP OF SLAB LEVEL

EXISTING STREET TREE

PROPOSED TREE

PROPOSED WSUD TREATMENT

PROPOSED PLANTING

TURF

DECK AREA

ACCESSIBLE PATH

PERGOLA AREA

PROJECT:  
LOTS 12 + 13 BUTU WARGUN DRIVE  
PEMULWAY

DRAWING TITLE:  
PLANTING PLAN 3/4

SCALE: 1:200 @A1  
CREATED: 16.08.2016  
DRAWN: ND

CHECKED: DMT  
JOB NO: 16-1265  
DESIGNED: AL

DRAWING NO:  
LA10

REVISION:  
D

D REDUCED GREEN ROOF 21.02.2018

C UPDATED GREEN ROOF 18.07.2017

B REVISED DA 27.02.2017

A REVISED DA 02.02.2017

ISSUE DESCRIPTION DATE

CLIENT:  
MINTUS HOLDINGS Pty. Ltd.ATF  
THE PEMULWUY INVESTMENT UNIT TRUST

0 2.5 5 10 15m

Copyright of Taylor Brammer Landscape Architects Pty Ltd.  
ABN 61 096 724 988





REFER LA06 FOR GREEN ROOF DETAILS

|         |          |
|---------|----------|
| LEGEND: |          |
|         | EX 18.25 |
|         | RL 20.0  |
|         | TW 21.0  |
|         | SL 24.00 |

SITE BOUNDARY  
EXISTING SPOT LEVEL  
PROPOSED SPOT LEVEL  
TOP OF WALL LEVEL  
TOP OF SLAB LEVEL

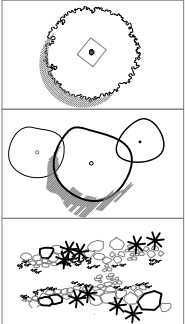

EXISTING STREET TREE  
PROPOSED TREE  
PROPOSED WSUD TREATMENT

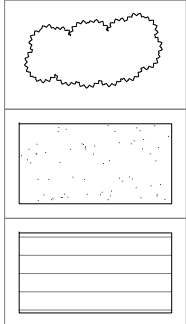

PROPOSED PLANTING  
TURF  
DECK AREA

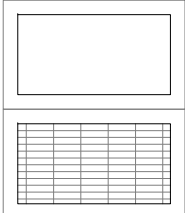

ACCESSIBLE PATH  
PERGOLA AREA

| ISSUE | DESCRIPTION        | DATE       |
|-------|--------------------|------------|
| D     | REDUCED GREEN ROOF | 21.02.2018 |
| C     | UPDATED GREEN ROOF | 18.07.2017 |
| B     | REVISED DA         | 27.02.2017 |
| A     | REVISED DA         | 02.02.2017 |

PROJECT:  
LOTS 12 + 13 BUTU WARGUN DRIVE  
PEMULWAY

DRAWING TITLE:  
PLANTING PLAN 4/4

CLIENT:  
MINTUS HOLDINGS Pty. Ltd.ATF  
THE PEMULWUY INVESTMENT UNIT TRUST

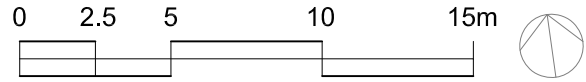

|                     |                 |             |           |
|---------------------|-----------------|-------------|-----------|
| SCALE: 1:250 @A1    | CHECKED: DMT    | DRAWING NO: | REVISION: |
| CREATED: 16.08.2016 | JOB NO: 16-1265 | LA11        | D         |
| DRAWN: ND           | DESIGNED: AL    |             |           |



